

RAIDON

iR2622S 快速安裝導引

產品示意圖與配件表

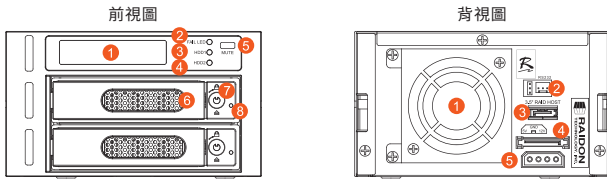

- | | | |
|-------------|-----------|--------------------|
| 1 液晶顯示面板 | 5 靜音按鈕 | 1 風扇 |
| 2 電源/故障顯示燈 | 6 硬碟抽取盒把手 | 2 RS232 埠 |
| 3 主硬碟狀態指示燈 | 7 卡榫按鍵 | 3 3.5" 硬碟 SATA 連結埠 |
| 4 次要硬碟狀態指示燈 | 8 硬碟讀取燈 | 4 SATA 15Pin 電源輸入埠 |
| | | 5 4Pin 電源輸入埠 |

打開包裝外盒後，包裝內容應包含下列組件：

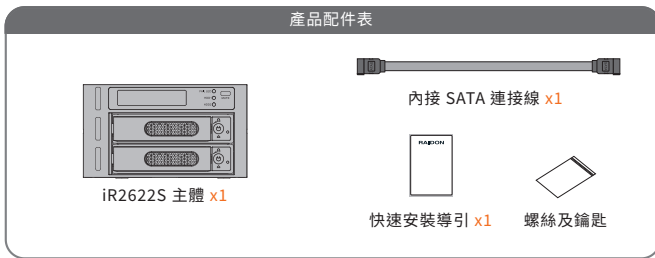

- 請先確認相關配件與產品本身是否有受損或是缺少配件，若有任何疑問，請與您的經銷商或業務人員聯絡。
- 請前往官網 (www.raidon.com.tw) 下載說明書、驅動程式以及其餘相關資源。



V1.1 (Mar. 2020)

1

硬體安裝

請參照以下步驟完成硬體安裝：

- 請使用零件包內附的鑰匙解鎖卡榫按鍵，再將按下卡榫按鍵，硬碟抽取盒把手便會彈開，即可取出抽取盒。



- 安裝 3.5 吋硬碟，請使用 6 顆零件包內附的大顆螺絲加以固定；安裝 2.5 吋硬碟，請使用 4 顆零件包內附的小顆螺絲加以固定。

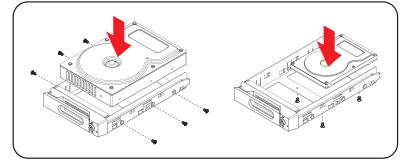

- 硬碟安裝完成後請將抽取盒平移放入主機內並關上把手。
- 將主體安裝於電腦機殼上的 CD-ROM 位置，並使用配件包裡的螺絲固定，並連接 SATA 連接線與 SATA 電源線。

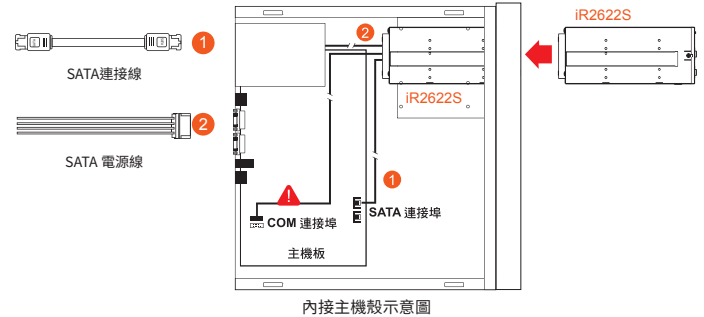

RS232連接埠和RS232連接線：提供工控產業或IPC產業透過RS232進行硬體狀態偵測，如有需要可向銳銳銷售/客服人員 supporting@raidon.com.tw 索取相關資料。

- 硬體安裝完成。一旦開啟電腦，您的作業系統會自動辨識所裝置好的硬碟。如果您的硬碟是必須被格式化的，請依照電腦的作業系統進行硬碟格式化步驟。當完成硬碟格式化後，硬碟便可以進行資料讀寫。

2

燈號說明

狀態	HDD 1	HDD 2	TRAY 1	TRAY 2	警示燈	蜂鳴器
待機	橘燈恆亮	N/A	藍燈恆亮	紅燈恆亮	N/A	N/A
資料存取	橘燈恆亮	N/A	紫燈閃爍	紅燈恆亮	N/A	N/A
HDD 1 故障	N/A	N/A	紅燈恆亮	紅燈恆亮	紅燈恆亮	鳴叫
HDD 2 故障	橘燈恆亮	N/A	藍燈恆亮	紅燈恆亮	紅燈恆亮	鳴叫
備份	橘燈恆亮	N/A	藍燈恆亮	紅燈閃爍	N/A	N/A
風扇故障	橘燈恆亮	N/A	藍燈恆亮	紅燈恆亮	紅燈恆亮	鳴叫
溫度過高 (≥50 °C)	橘燈恆亮	N/A	藍燈恆亮	紅燈恆亮	紅燈恆亮	鳴叫

LCD顯示的各種訊息

- 開機與正常待機狀態



- 風扇故障



- 溫度過高 (≥50 °C)

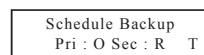

- HDD1 損毀而 HDD2 仍然正常存在

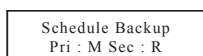

- HDD2 損毀或未安裝而 HDD1 仍然可正常存取

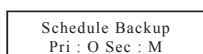

產品使用注意事項

- 電腦或伺服器具備 SATA I-SATA II 或 SATA III 介面。
- 具備 SATA I-SATA II 或 SATA III 介面的硬碟。
- 本系統允許使用不同廠牌的硬碟。但如果要獲得更好的效能，我們強烈建議使用相同廠牌型號的硬碟。
- 第一次使用本產品進行設定時，資料會被全數清除。請於硬碟置入前，確認硬碟已備份，避免資料遺失。
- 安裝硬碟前請先確認所使用的硬碟並無壞軌或是其他問題，以免導致系統損毀或資料遺失。
- 硬碟格式化後的可使用儲存容量會小於硬碟標示的容量。
- 強烈建議除了使用 iR2622S 的資料儲存功能外，請針對重要資料備份到另一個儲存裝置上或遠端備份，雙重備援您重要的資料。若您儲存在 iR2622S 的資料損毀或遺失，RAIDON 將不負任何的責任。

感謝您使用 銳銳科技股份有限公司 的產品。本手冊裡的資訊在出版前雖然已經被詳細確認，但實際產品規格將以出貨時為準；任何的產品規格或相關資訊更新，請您直接上 www.RAIDON.com.tw 網站查詢，或是直接與您的業務聯絡窗口聯繫，本公司將不另行通知。

如果您對 銳銳科技 的產品有任何疑問，或是想獲得最新產品訊息、使用手冊或軟體，請您聯絡 supporting@raidon.com.tw，我們將儘速回覆您。

RAIDON 為 銳銳科技股份有限公司 旗下品牌之一
本說明相關產品內容歸 銳銳科技股份有限公司 版權所有

3

4

RAIDON

iR2622S Quick Setup Guide

Package Contents and Product Views

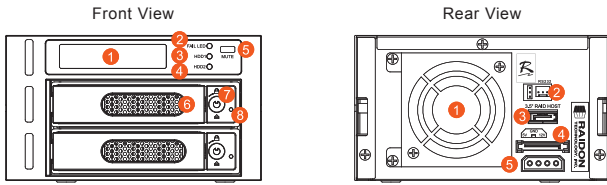

- | | | |
|-----------------------------|------------------------|--------------------------|
| 1 LCD Display | 5 Mute Button | 1 Fan |
| 2 LED of failure Alarm | 6 Removable drive tray | 2 RS232 Port |
| 3 Pri. HDD status indicator | 7 HDD tray key lock | 3 SATA Port |
| 4 Sec. HDD status indicator | 8 HDD Access | 4 15 PIN Power Connector |
| | | 5 4Pin Power Connector |

After you open the outer package, make sure that the following items are contained in the package:

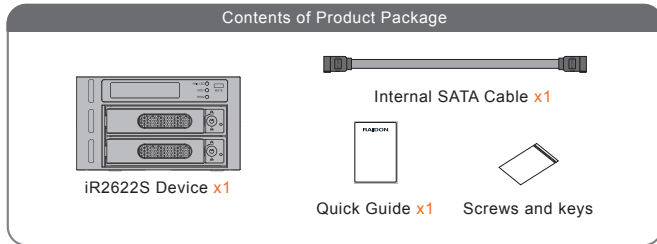

- Please check the product and accessories for any defect or missing parts. If you have any questions, please contact your product supplier.
- Please visit the official website - Download page (<https://www.raidon.com.tw>) to download drivers and other related resources.



V1.1 (Mar. 2020)

1

Hardware Installation

Please install iR266S as the following instruction.

- Use the key included in the accessory kit to unlock the HDD tray key lock, and then press the HDD tray key lock. The removable drive tray will pop open and extract the removable drive tray.



- For 3.5" HDD/SSD, please secure it by use six the larger screws included in the accessory kit. For 2.5" HDD/SSD, please secure it by use four the smaller screws included in the accessory kit.

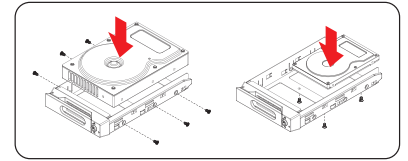

- Choose one of the provided cables of your preference to connect the preferred interface connection on the enclosure unit to the computer.
- Install device into one of the CD-ROM bays with screws from the accessory kit. Then properly connect SATA cable and SATA power cable from your system to the device.

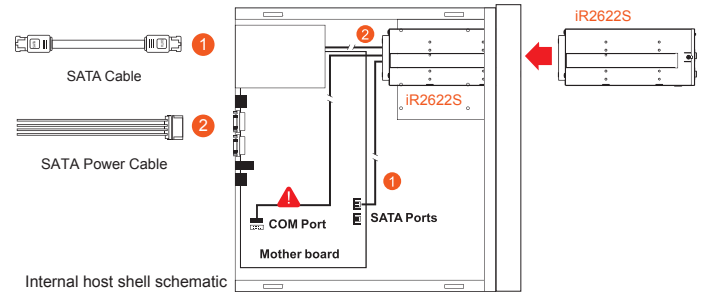

NOTE RS232 Port: For industrial control system or IPC to monitor the hardware status. More information, please contact your sales window or supporting@raidon.com.tw

- Power on your system after hardware installation is completed, and your operating system will automatically detect the hard drives from booting. Then follow the steps from your operating system to partition and format the drives when necessary, device will be ready to use once the format is completed.

2

LED Instruction

Status	HDD 1	HDD 2	TRAY 1	TRAY 2	Fail LED	Buzzer
HDD Idle	Orange light always on	N/A	Blue light always on	Red light always on	N/A	N/A
Access	Orange light always on	N/A	Purple light flashing	Red light always on	N/A	N/A
HDD 1 Failure	N/A	N/A	Red light always on	Red light always on	Red light always on	on
HDD 2 Failure	Orange light always on	N/A	Blue light always on	Red light always on	Red light always on	on
Backup	Orange light always on	N/A	Blue light always on	Red light flashing	N/A	N/A
Fan Failure	Orange light always on	N/A	Blue light always on	Red light always on	Red light always on	on
Overheat (≥50°C)	Orange light always on	N/A	Blue light always on	Red light always on	Red light always on	on

LED Instruction

- Bootling and Normal status.



- Fan Failure

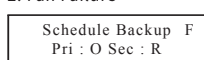

- Over Temperature (≥50°C)

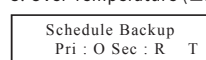

- HDD1 is corrupted while HDD2 still exists.

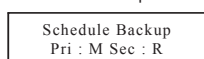

- HDD2 is corrupted or not installed while HDD1 is still accessible.

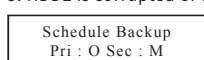

3

Important Notice

- Computers or servers must be with SATA I, SATA II, or SATA III.
- Hard drive must be with SATA I, SATA II, or SATA III.
- Once the drive mode configuration has been completed, re-configuration using the same hard drives to set the drive mode will result in complete data loss. If you must change the drive mode, make sure to backup all data prior to the mode change.
- All existing data will be deleted when this product is set up for the first time. Please ensure that all data on the hard disk has been backed up before installation to avoid data loss.
- Please make sure that the two hard drives are free from bad blocks or defects prior to installation in order to avoid system crashes or data loss.
- The usable storage capacity of the hard disk after formatting will be less than the capacity indicated on the hard disk.
- It is highly recommended for user to back up important data contained within the iR2622S unit on a regular basis or whenever the user feels necessary to a remote or a separate storage device. RAIDON will not be responsible for any lost of data caused during the use of the unit or the recovery of the data lost.

Thank you for choosing product from **RAIDON Technology Inc.** This information in the manual has been thoroughly checked before publication, but may not conform to the product actually delivered which mean actual product specifications depend on the product shipped to you. Any update in the specifications or product-related information shall not be subject to further notice but for the latest information on the product, please visit the website as www.RAIDON.com.tw or contact us at supporting@raidon.com.tw, and we will get back to you as soon as possible.

RAIDON is one brand under RAIDON TECHNOLOGY, INC.

Copyright © RAIDON TECHNOLOGY, INC. All rights reserved.

4